



2024

Courses: Course will be denoted by a numerical placard displayed on the race deck or committee boat at or before your preparatory signal.

Marks: Marks are indicated by numbered red buoys. Mark 4 is the island and it is not marked. Mark locations are approximate. Direction is determined by the letter (p-port or s-starboard) following the number on the course sheet.

Starting: The starting line is between green buoys A and B. All boats must maintain a position northeast of the docks until their warning signal. The area west of the docks is restricted to starting boats only. Any boat whose warning signal has not been made shall keep clear of the starting area. The Start/Finish line is closed; do not cross it unless starting or finishing a race.

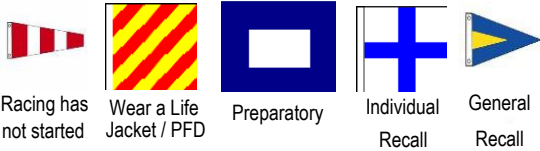
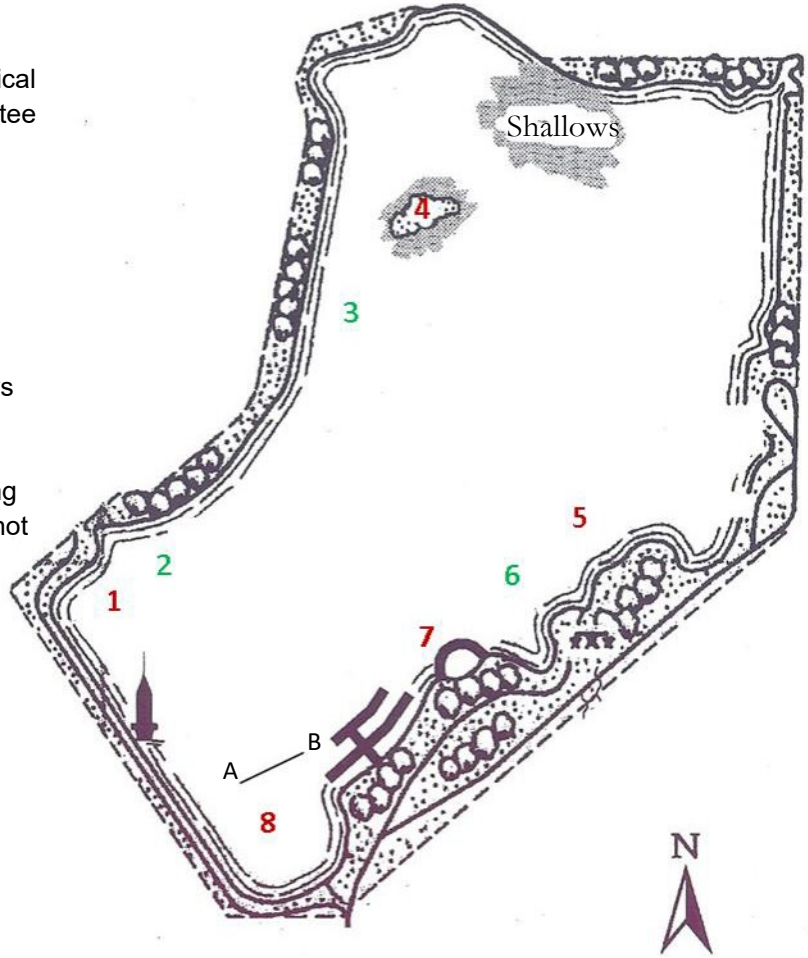

Flag Sequence:
 5 Minutes before the start: Class flag up
 4 Minutes before the start: Preparatory flag up
 1 Minute before the start: Preparatory flag down
 Start: Class flag down / next Class flag

COURSES

#	Marks											NM			
1	S	1s	7p	2p	8p	F							1.56		
2	S	1s	8p	1s	7p	2p	8p	F					2.32		
3	S	1s	7p	3s	6s	2p	8p	F					2.56		
4	S	1s	3s	5p	4p	6s	2p	8p	F				3.26		
5	S	1s	7p	3s	6s	3s	6s	2p	8p	F			3.39		
6	S	1s	7p	3s	5p	4p	6s	2p	8p	F			3.61		
7	S	1s	7p	4p	5p	4p	6s	2p	8p	F			3.84		
8	S	1s	3s	5p	4p	6s	3s	6s	2p	8p	F		4.09		
9	S	1s	7p	3s	6s	3s	5p	4p	5p	4p	6s	2p	8p	F	5.40